

AXOR

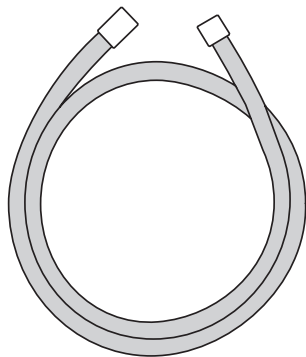



DE / Montageanleitung
FR / Instructions de montage
EN / Assembly instructions
IT / Istruzioni per Installazione
ES / Instrucciones de montaje
NL / Handleiding
DK / Monteringsvejledning
PT / Manual de Instalação
PL / Instrukcja montażu
CS / Montážní návod
SK / Montážny návod
ZH / 组装说明
RU / Инструкция по монтажу
HU / Szerelési útmutató
FI / Asennusohje
SV / Monteringsanvisning
LT / Montavimo instrukcijos
HR / Uputstva za instalaciju
TR / Montaj kılavuzu
RO / Instrucțiuni de montare
EL / Οδηγία συναρμολόγησης
SL / Navodila za montažo
ET / Paigaldusjuhend
LV / Montāžas instrukcija
SR / Uputstvo za montažu
NO / Montasjeveiledning
BG / Инструкция за употреба
SQ / Udhëzime rreth montimit
AR / تعليمات التجميع
JP / 施工説明書



AXOR Starck
28282XXX (1,25 m)
28284XXX (2,00 m)
28286XXX (1,60 m)
AXOR
28622XXX (1,25 m)
28624XXX (2,00 m)
28626XXX (1,60 m)

INSTALLATION

AXOR

	P	max. 0,6 MPa 6 bar	0 - 0,4 MPa 0 - 4 bar	
	T	max. 60 °C	< 50 °C	

Classification acoustique
et débit: NF

Test certificate: DVGW CQ0363

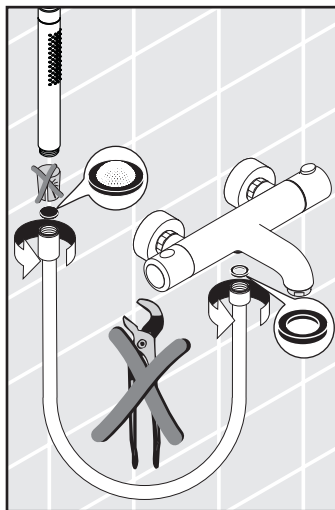

AXOR / Hansgrohe SE

Austraße 5-9

77761 Schiltach

Deutschland

info@axor-design.com

axor-design.com

01/2022
9.01584.01