

Stylish planning with confidence: use the AXOR ComfortZone test to find the right wash basin for your AXOR Citterio mixer.



The ideal mixer/wash basin combination: perfectly matched aesthetically, and technologically tested. This prevents any annoying splashing and staining around the wash basin area.



AXOR tested all the AXOR Citterio basin mixers with the leading manufacturers' most popular washbasins in the ComfortZone test, its specially developed realistic test procedure. The space under the mixer and the splash behaviour are tested in this performance test of mixer and basin. Detailed information on the ComfortZone test can be found at:

[pro.hansgrohe.com/consultation/comfortzone](https://pro.hansgrohe.com/consultation/comfortzone)

## Ceramic types

Always find the matching AXOR Citterio mixer to go with the familiar basin types. The AXOR ComfortZone test is a comprehensive guidance document for the perfect installation of the mixer and washbasin for pleasant, splash-free washing. Five different ceramic types were tested in the AXOR ComfortZone test:

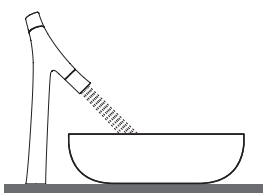

Washbasin with the mixer behind it

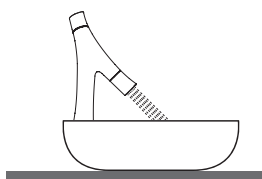

Washbasin with the mixer on top of it

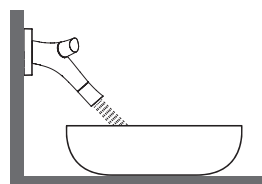

Washbasin with the mixer on the wall

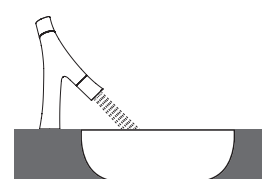

Undermount or top-mounted basin with free standing mixer

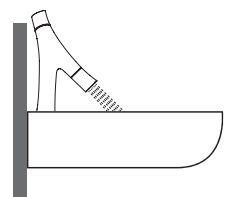

Wall-mounted washbasin with the mixer on it

You can use the results of the ComfortZone test free now at:

[pro.hansgrohe.com/consultation/comfortzone](https://pro.hansgrohe.com/consultation/comfortzone)

Manufacturer and washbasin line

Welche AXOR Citterio Armatur passt zu welchem Waschbecken?

**AXOR Citterio**

	Waschbecken Hersteller # 23000000	Waschbecken Hersteller # 23000000	Waschbecken Hersteller # 23000000	Waschbecken Hersteller # 23000000	Waschbecken Hersteller # 23000000
<b>Duravit</b>					
<b>Vero Ar</b>					
181 1/2	# 273440000				
282 1/2	# 273440000				
181 1/2	# 230000000				
182 1/2	# 230000000				
282 1/2	# 230000000				
283 1/2	# 230000000				
181 1/2	# 230000000				
182 1/2	# 230000000				
282 1/2	# 230000000				
283 1/2	# 230000000				
<b>Happy Q-2 Plus</b>					
282 1/2	# 230000000				
283 1/2	# 230000000				
284 1/2	# 230000000				
<b>Vu</b>					
180 1/2	# 230000000				

a1 = 40mm a2 = 40mm a3 = 50mm a4 = 100mm  
 b1 = 20mm b2 = 20mm b3 = 20mm b4 = 100mm  
 c1 = 15mm c2 = 15mm  
 d1 = 0mm d2 = 40mm d3 = 20mm d4 = 20mm d5 = 100mm d6 = 100mm d7 = 100mm  
 e1 = 20mm e2 = 20mm e3 = 20mm e4 = 20mm

\* Kombination empfohlen / ● = Hahnlöch durchgetaschen / ○ = Hahnlöch vorgeschnitten / ⊗ = ohne Hahnlöch  
 1/2 Hahnlöch  
 1/2 ohne Hahnlöch  
 Hahnlöch in mm

AXOR Citterio

mixer and item number

Recommended combinations

Washbasin with item number and details of size (different item numbers refer to different version of taphole and overflow versions)

Mounting dimensions for different installation situations

Information washbasin type

✓ = Recommended combination / ● = Taphole pushed through / ○ = Prepared taphole / ⊗ = Without taphole

Lesezeichen

Duravit

The table of contents makes it easy to get to your chosen ceramic line.

# Which AXOR Citterio mixer suits which basin ?



AXOR Citterio						
		Basin mixer 90	Basin mixer 160	Basin mixer 280	Single lever basin mixer 220 for concealed installation wall-mounted with lever	Basin mixer 110
		#39022000 #39035000	#39023000 #39031000	#39021000 #39020000	#39115000 #39116000 #39119000	#39010000
<b>Hansgrohe</b>						
<b>MoonWake</b>						
		1 h 3 h w/o	#2242100		✓ b2	✓ d4, c2
		1 h 3 h w/o	# 22417007		✓	
<b>Cube Stark</b>						
		1 h 3 h w/o	#22414007		✓ a3	✓ d2, c2
		1 h 3 h w/o	#22410007		✓	
<b>Duravit</b>						
<b>Bacino</b>						
	155	1 h 3 h w/o	# 033342000			✓ de, c2
<b>P3 Comforts</b>						
	110 x 510 x320	1 h 3 h w/o	# 0377550000			✓ d3, c2
	145 x 600 x 100	1 h 3 h w/o	# 2332650000 # 2332650030		✓	

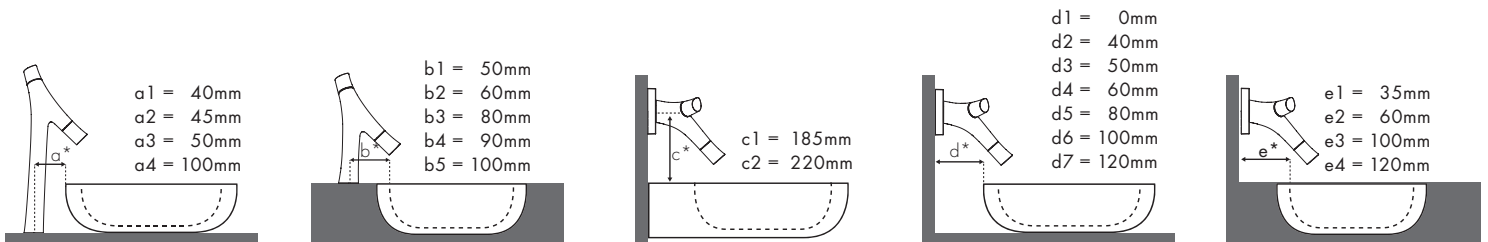

✓ = Recommended combination / ● = Taphole pushed through / ○ = Prepared taphole / ⊗ = Without taphole

1 h = 1 tap hole  
 2 h = 2 tap hole  
 w/o = without tap hole

ALL measurements in mm.



# Which AXOR Citterio mixer suits which basin ?



AXOR Citterio							
			Basin mixer 90	Basin mixer 160	Basin mixer 280	Single lever basin mixer 220 for concealed installation wall-mounted with lever	Basin mixer 110
			#39022000 #39035000	#39023000 #39031000	#39021000 #39020000	#39115000 #39116000 #39119000	#39010000
<b>Duravit</b>							
<b>ME by Starck</b>							
	180 x 630 x 480/290	1 h 3 h w/o	# 2336630000 # 2336630030 # 2336630060	✓			✓
	110 x 450 x 425/195	1 h 3 h w/o	# 0719450000 # 0719450060	✓			✓
<b>Starck 3</b>							
	150 x 530 x 490/365	1 h 3 h w/o	# 0305490000	✓ b1	✓ b1		✓ e2, c2
<b>Dura Square</b>							
	110 x 600/335	1 h 3 h w/o	# 2353600041 # 2353600044 # 2353600070		✓		✓ c2
	80 x 600/335	1 h 3 h w/o	# 2354600041 # 2354600044 # 2354600070		✓		✓ d1, c2
	105 x 450/230	1 h 3 h w/o	#0732450041 #0732450070				✓
	80 x 600/335	1 h 3 h w/o	#2355600000				✓ d3, c2

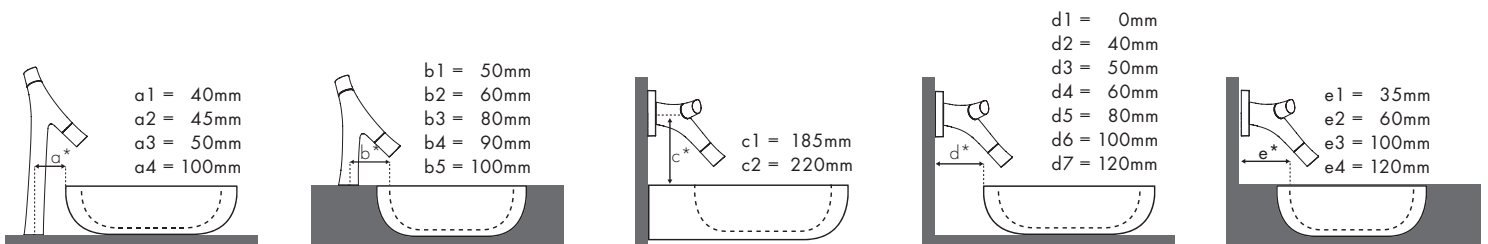

✓ = Recommended combination / ● = Taphole pushed through / ○ = Prepared taphole / ⊗ = Without taphole













1 h = 1 tap hole  
 2 h = 2 tap hole  
 w/o = without tap hole

ALL measurements in mm.



# Which AXOR Citterio mixer suits which basin ?



AXOR Citterio								
				Basin mixer 90	Basin mixer 160	Basin mixer 280	Single lever basin mixer 220 for concealed installation wall-mounted with lever	Basin mixer 110
				#39022000 #39035000	#39023000 #39031000	#39021000 #39020000	#39115000 #39116000 #39119000	#39010000
<b>Duravit</b>								
<b>Vero Air</b>								
	115 x 400/ 205	1 h 3 h w/o	# 0724450000 # 0724450060	✓				
	115 x 550/ 315	1 h 3 h w/o	# 2350600000 # 2350600030 # 2350600060	✓	✓		✓ d1, c2	
	120 x 445/ 325	1 h 3 h w/o	# 2351500000			✓ a3	✓ d4, c2	
	115 x 450/ 315	1 h 3 h w/o	# 2352500000 # 2352500030 # 2352500060		✓		✓ d1, c2	
<b>Happy D.2 Plus</b>								
	120 x 375/ 375	1 h 3 h w/o	# 2359400000			✓ a4	✓ d4, c2	
	125 x 575/ 230	1 h 3 h w/o	# 2360600000 # 2360600060		✓		✓ d1, c2	
<b>Viu</b>								
	100	1 h 3 h w/o	# 2358600000			✓ a1	✓ d3, c2	

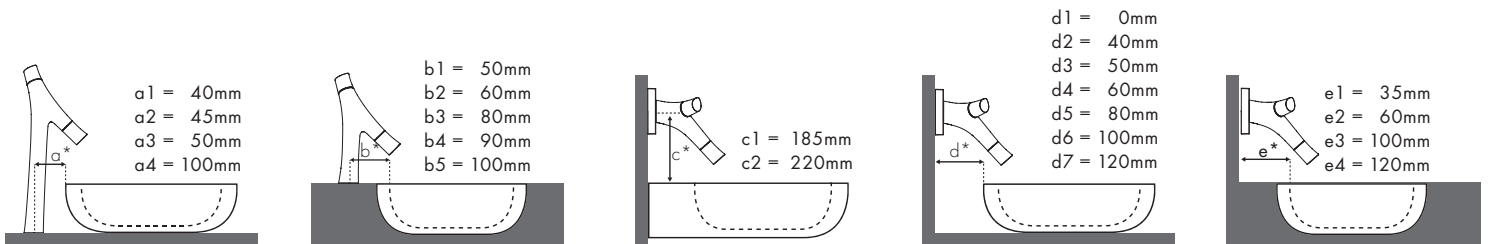

✓ = Recommended combination / ● = Taphole pushed through / ○ = Prepared taphole / ⊗ = Without taphole

1 h = 1 tap hole  
2 h = 2 tap hole  
w/o = without tap hole

ALL measurements in mm.



# Which AXOR Citterio mixer suits which basin ?



AXOR Citterio						
		Basin mixer 90	Basin mixer 160	Basin mixer 280	Single lever basin mixer 220 for concealed installation wall-mounted with lever	Basin mixer 110
		#39022000 #39035000	#39023000 #39031000	#39021000 #39020000	#39115000 #39116000 #39119000	#39010000
<b>Laufen</b>						
<b>Val</b>						
	110 x 450/ 300	1 h 3 h w/o	#315281 #315281 #315281	✓	✓	✓ d5, c2
	110 x 600/ 300	1 h 3 h w/o	#810283.104 #810283.108 #810283.109	✓	✓	✓d1, c2
	110 x 400/ 280	1 h 3 h w/o	#813281 .104 #813281 .109		✓	
	100 x 305/ 305	1 h 3 h w/o	#817281 .106 #817281 .109		✓	✓ d5, c2
	115 x 438/ 294	1 h 3 h w/o	# 816280		✓	✓ d1, c2
<b>Sonar</b>						
	100 x 600/ 310	1 h 3 h w/o	#810342 .104 #810342 .108 #810342 .109		✓	✓ d1, c2
<b>Kartell</b>						
	120 x 444/ 380	1 h 3 h w/o	#815331		✓	

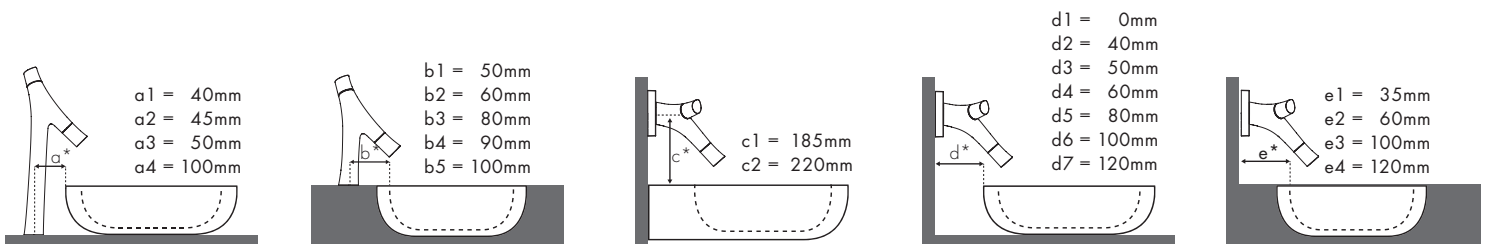

✓ = Recommended combination / ● = Taphole pushed through / ○ = Prepared taphole / ⊗ = Without taphole

1 h = 1 tap hole  
 2 h = 2 tap hole  
 w/o = without tap hole

ALL measurements in mm.



# Which AXOR Citterio mixer suits which basin ?



<b>AXOR Citterio</b>								
				Basin mixer 90	Basin mixer 160	Basin mixer 280	Single lever basin mixer 220 for concealed installation wall-mounted with lever	Basin mixer 110
				#39022000 #39035000	#39023000 #39031000	#39021000 #39020000	#39115000 #39116000 #39119000	#39010000
<b>Geberit</b>								
<b>Smyle/Smyle Square</b>								
		110 x 468/274	1 h 3 h w/o	# 500.256.01.1	✓			
		120 x 568/334	1 h 3 h w/o	# 500.229.01.1	✓			
		120 x 568/334	1 h 3 h w/o	# 500.228.01.1	✓	✓		✓

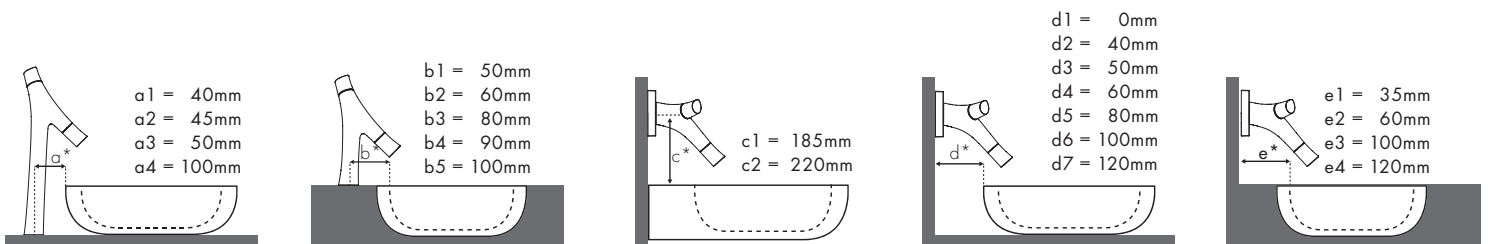

✓ = Recommended combination / ● = Taphole pushed through / ○ = Prepared taphole / ⊗ = Without taphole

1 h = 1 tap hole  
 2 h = 2 tap hole  
 w/o = without tap hole

ALL measurements in mm.



# Which AXOR Citterio mixer suits which basin ?



AXOR Citterio									
				Basin mixer 90	Basin mixer 160	Basin mixer 280	Single lever basin mixer 220 for concealed installation wall-mounted with lever	Basin mixer 110	
				#39022000 #39035000	#39023000 #39031000	#39021000 #39020000	#39115000 #39116000 #39119000	#39010000	
<b>Bette</b>									
<b>Bette One</b>									
		1 h 3 h w/o	# A127-000	✓	✓		✓ d1, c2	✓	
	130 x 394/ 375	1 h 3 h w/o	# A135		✓ b2		✓ e2, c2		
	130 x 547/ 368	1 h 3 h w/o	# A136		✓ b2		✓ e1, c2		
<b>BetteLoft</b>									
	100 x 700/ 366	1 h 3 h w/o	# A230		✓		✓ d1, c2		
<b>BetteArt</b>									
	400/ 400	1 h 3 h w/o	# A181			✓ a1	✓ d4, c2		

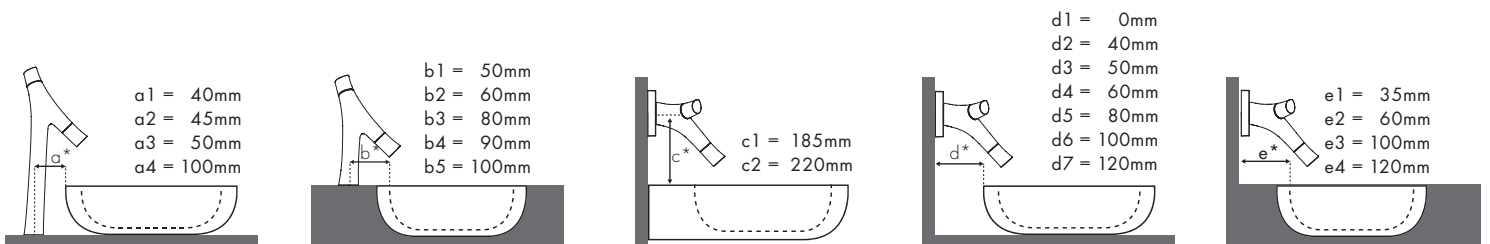

✓ = Recommended combination / ● = Taphole pushed through / ○ = Prepared taphole / ⊗ = Without taphole

1 h = 1 tap hole  
2 h = 2 tap hole  
w/o = without tap hole







ALL measurements in mm.



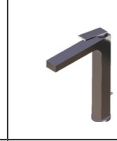
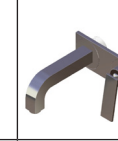

# Which AXOR Citterio mixer suits which basin ?

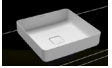
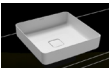

AXOR Citterio								
				Basin mixer 90	Basin mixer 160	Basin mixer 280	Single lever basin mixer 220 for concealed installation wall-mounted with lever	Basin mixer 110
				#39022000 #39035000	#39023000 #39031000	#39021000 #39020000	#39115000 #39116000 #39119000	#39010000
<b>Kaldewei</b>								
<b>Miena</b>								
		1 h 3 h w/o	# 3184			✓ a3	✓ d5, c2	
	580 x 380	1 h 3 h w/o	# 3185			✓ a3	✓ d5, c2	
<b>Roca</b>								
<b>Inspira</b>								
	140 x 500	1 h 3 h w/o	# A32753000M			✓ a3	✓ d3, c2	

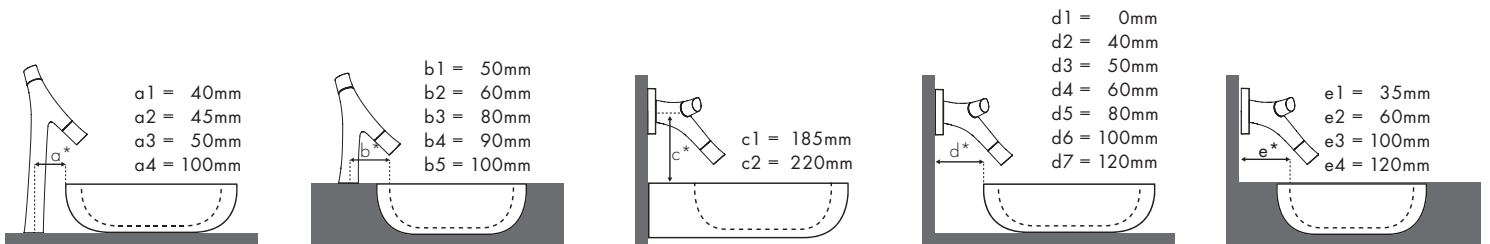

✓ = Recommended combination / ● = Taphole pushed through / ○ = Prepared taphole / ⊗ = Without taphole

1 h = 1 tap hole  
 2 h = 2 tap hole  
 w/o = without tap hole

ALL measurements in mm.



# Which AXOR Citterio mixer suits which basin ?



AXOR Citterio								
				Basin mixer 90	Basin mixer 160	Basin mixer 280	Single lever basin mixer 220 for concealed installation wall-mounted with lever	Basin mixer 110
				#39022000 #39035000	#39023000 #39031000	#39021000 #39020000	#39115000 #39116000 #39119000	#39010000
<b>Vitra</b>								
Nuo								
	155 x 380	1 h 3 h w/o	# 7436B403-0012				✓ d2, c2	
	155 x 440	1 h 3 h w/o	# 7432B003-0661		✓			
Geo								
	170 x 395	1 h 3 h w/o	# 7425B403-0016			✓ a1	✓ d2, c2	
Equal								
	165 x 450	1 h 3 h w/o	# 7241B403-0631		✓			
<b>Villeroy &amp; Boch</b>								
Collaro								
	85 x 470/325	1 h 3 h w/o	#4A3361		✓			
	100 x 360	1 h 3 h w/o	# 4A2056			✓ a3	✓ d2, c2	

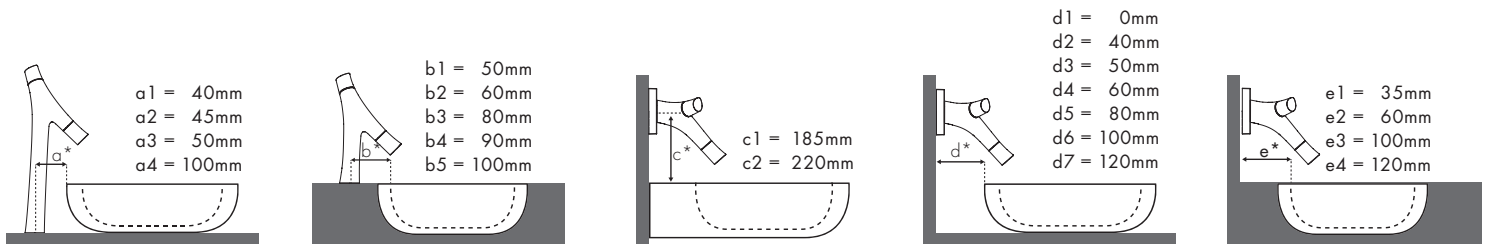

✓ = Recommended combination / ● = Taphole pushed through / ○ = Prepared taphole / ⊗ = Without taphole

1 h = 1 tap hole  
 2 h = 2 tap hole  
 w/o = without tap hole

ALL measurements in mm.



# Which AXOR Citterio mixer suits which basin ?



<b>AXOR Citterio</b>					
	Basin mixer 90	Basin mixer 160	Basin mixer 280	Single lever basin mixer 220 for concealed installation wall-mounted with lever	Basin mixer 110
	#39022000 #39035000	#39023000 #39031000	#39021000 #39020000	#39115000 #39116000 #39119000	#39010000

## Villeroy & Boch

<b>Memento 2.0</b>								
	90 420x (275)	1 h 3 h w/o	#4A0760 #4A0760		✓			
	90 260x 400 (280)	1 h 3 h w/o	#43234G	✓				✓
<b>Finion</b>								
	100 600x 445 (310)	1 h 3 h w/o	#414260		✓			
	100 x 500 (350)	1 h 3 h w/o	#416480 #416480		✓			

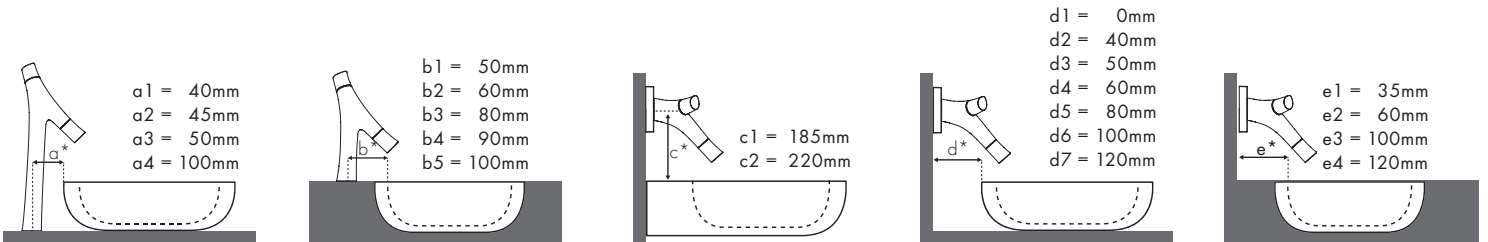

✓ = Recommended combination / ● = Taphole pushed through / ○ = Prepared taphole / ⊗ = Without taphole

1 h = 1 tap hole  
 2 h = 2 tap hole  
 w/o = without tap hole

ALL measurements in mm.

