

Montageanleitung

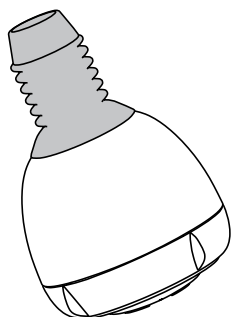

Mistral
28444XXX

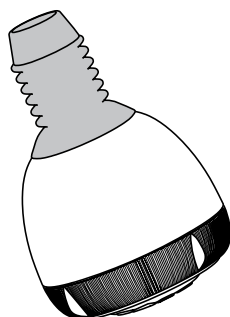

Selecta
28447XXX

hansgrohe

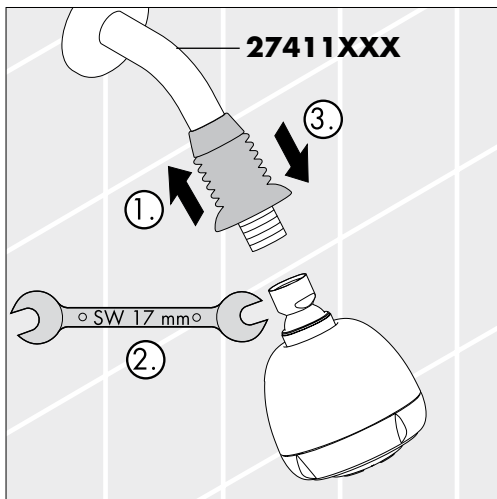
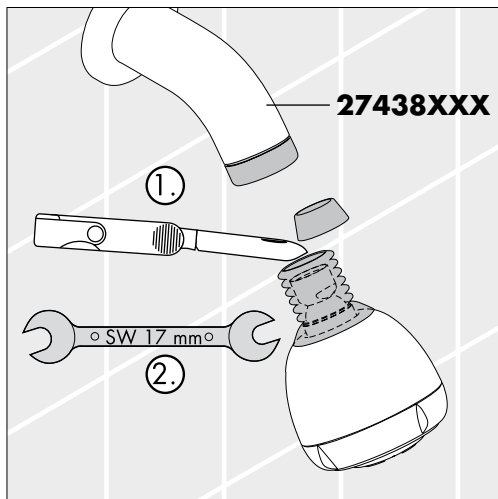

Mistral 28444XXX

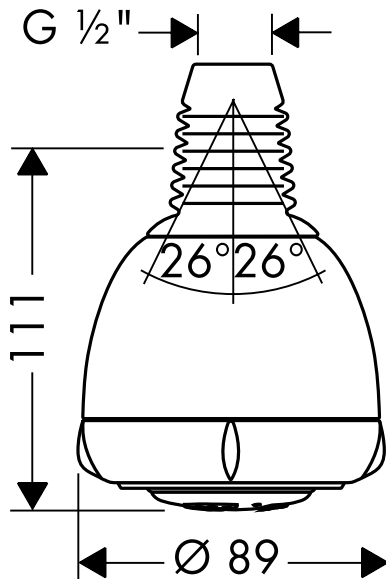

Selecta 28447XXX

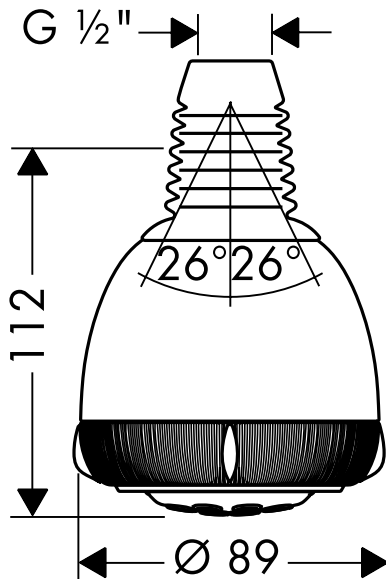

Mistral 28444XXX

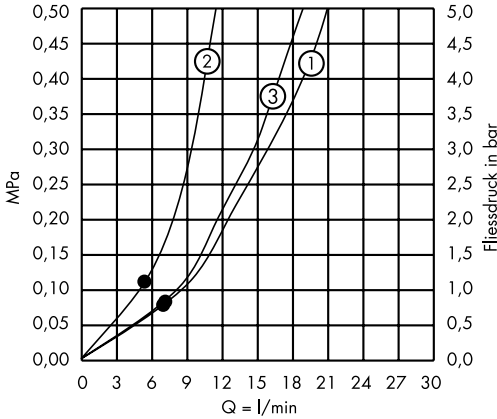

Ab • ist die Funktion gewährleistet.
 A partir de • le fonctionnement est garanti.
 From • the function is guaranteed.
 Dal • si garantisce la funzionalità.
 Mínimo • para el correcto funcionamiento.
 Vanaf • is het functioneren gegarandeerd.
 Fra • er funktionen anvendelig.
 • A partir deste ponto inicia-se o funcionamento correcto.
 Od • możliwe jest funkcjonowanie

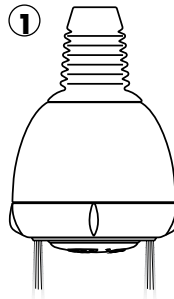

①
 Normalstrahl
 Jet de pluie
 Normal spray
 Getto normale a pioggia
 Chorro de lluvia
 Normale douchestraal
 Normalstråle
 Operação normal
 Strumień normalny

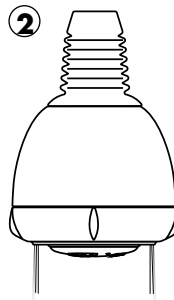

②
 Ecostrahl
 Jet de eco
 Eco spray
 Getto eco
 Chorro eco
 Ecostraal
 Eco brus
 Operação Eco
 Strumień Eco

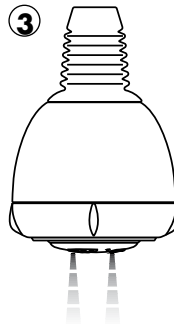

③
 Massagestrahl
 Jet de massage
 Massage jet
 Getto massaggio
 Chorro masajé
 Massagestraal
 Massagebrus
 Operação massajem
 Strumień masujący

Selecta 28447XXX

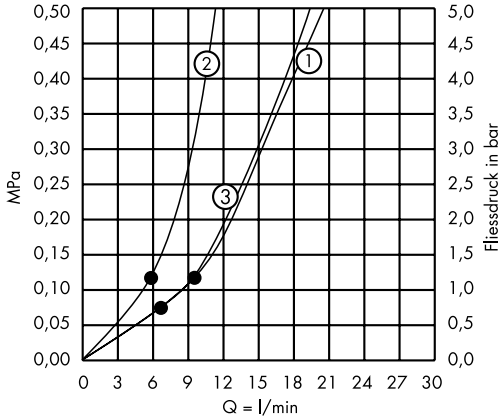

Ab • ist die Funktion gewährleistet.
 A partir de • le fonctionnement est garanti.
 From • the function is guaranteed.
 Dal • si garantisce la funzionalità.
 Mínimo • para el correcto funcionamiento.
 Vanaf • is het functioneren gegarandeerd.
 Fra • er funktionen anvendelig.
 • A partir deste ponto inicia-se o funcionamento correcto.
 Od • możliwe jest funkcjonowanie

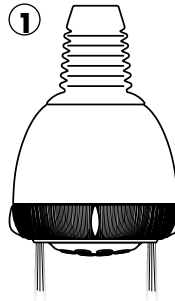

①
 Normalstrahl
 Jet de pluie
 Normal spray
 Getto normale a pioggia
 Chorro de lluvia
 Normale douchestraal
 Normalstråle
 Operação normal
 Strumień normalny

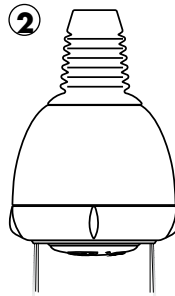

②
 Ecostrahl
 Jet de eco
 Eco spray
 Getto eco
 Chorro eco
 Ecostraal
 Ecobrus
 Operação Eco
 Strumień Eco

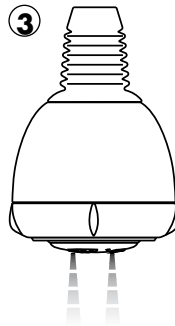

③
 Softstrahl
 Jet doux aéré
 Soft spray
 Getto areato
 Chorro espumoso
 Softstraal
 Softstråle
 Operação soft
 Strumień miękki

Mit Rubit[®], der manuellen Reinigungsfunktion können die Strahlformer durch einfaches rubbeln vom Kalk befreit werden.

La pomme de douche est équipée de Rubit[®], le système anticalcaire manuel. Les dépôts de calcaire s'enlèvent en frottant avec un doigt ou avec une éponge sur les ouvertures de jets élastiques.

The Rubit[®] cleaning function only needs a small manual rub over to remove the lime scale from the spray channels.

Con Rubit[®], la funzione anticalcare manuale, i diffusori del getto possono essere liberati da calcare con un semplice strofinamento.

Rubit[®], la función de limpieza manual, permite quitar la cal simplemente frotando los ejectores.

Met Rubit[®], de handmatige reinigingsfunctie, kunnen de straalopeningen door het met de hand wegwrijven van kalk, gereinigd worden.

Med Rubit[®], den manuelle rengøringsfunktion kan strålekanalerne let renses for kalk - der skal blot gnubbes!

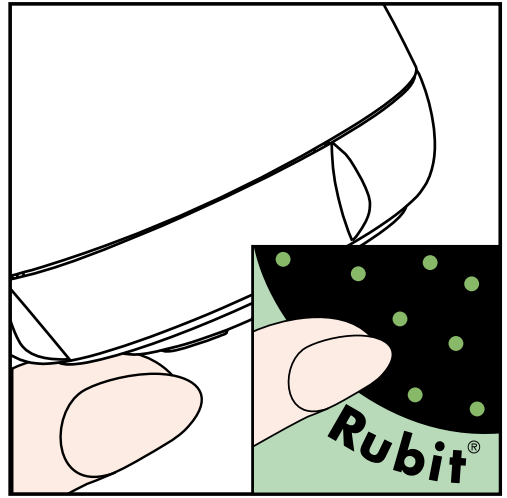

O sistema de limpeza Rubit[®] requer apenas uma ligeira passagem com a mão para remover os depósitos de calcário do emulsor.

Funkcja Rubit[®] wymaga jedynie delikatnego potarcia dłonią, aby usunąć ewentualne osady kamienia wapiennego.

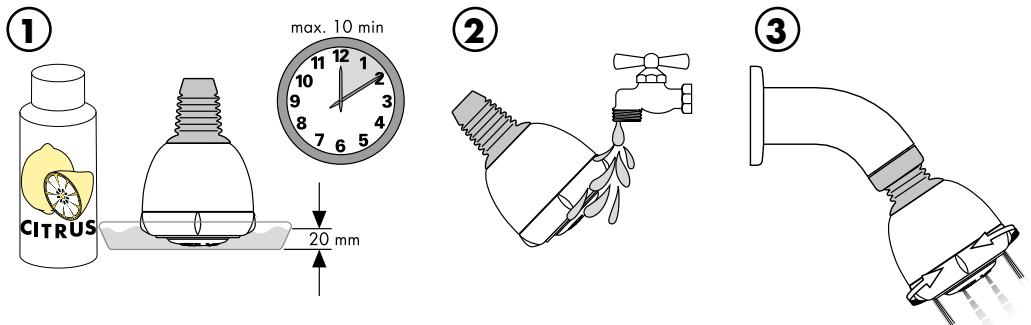

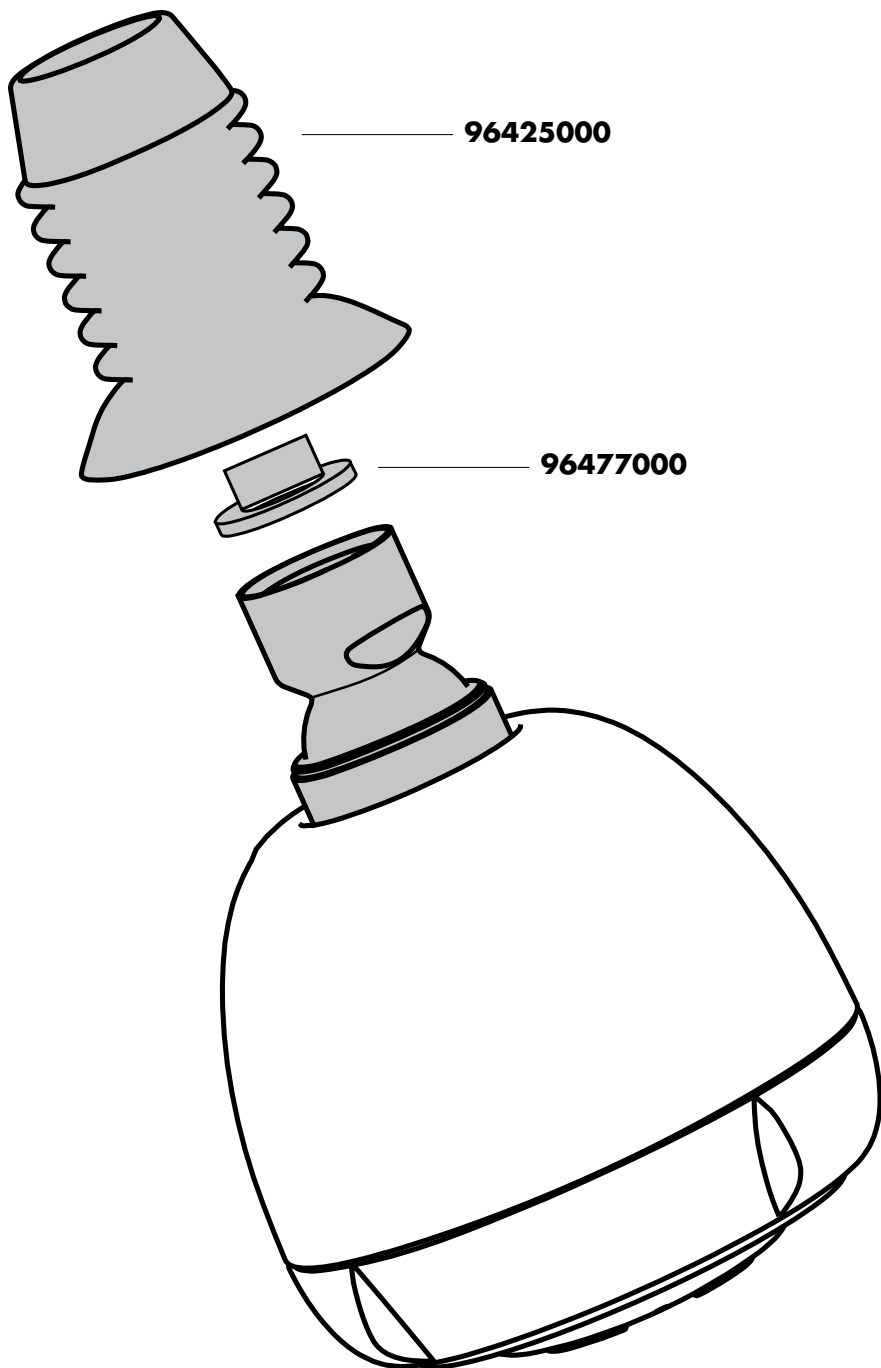



A

Hansgrohe
Postfach 85
2355 Wr. Neudorf
Telefon: 0 22 36 / 6 28 30
Telefax: 0 22 36 / 62 83 019

CH

Hansgrohe
Industriest. 9
5432 Neuenhof
Telefon: 056/416 26 26
Telefax: 056/416 26 27

E

Hansgrohe
Riera Can Pahissa 26 B
08750 Molins de Rei
Telefon: 93 680 39 00
Telefax: 93 680 39 09

GR

Nikitas Vlachos
Niveco SA
Posidonou Ave 46
17561 P. Falira
Telefon: (01) 9880180
Telefax: (01) 9883847

IND

Jaquar Mercantile
D-26, SMA Co-operative Industrial Estate
G.T. Karnal Road
Delhi-110033
Tel.: +91-11-27464808-17
Fax: +91-11-27240388, 27466808

PL

Hansgrohe
Ul. Sowia 12
PL-62-080 Tarnowo Podgórze
Telefon: (061) 8168600
Telefax: (061) 8168609

S

Hansgrohe AB
Ridsögatan 10
S-21377 Malmö
Telefon: +46/(0)40/51 91 50
Telefon: +46/(0)40/13 05 92

TR

Dizayn Ev Gerecleri
San. ve Tic. Ltd. Sti.
Ortaklar Cad. No. 1
Mecidiyekoye/Istanbul 80290
Tel.: 0090-212-266 50 80
Fax: 0090-212-275 75 12

AL

Hansgrohe AG
Region Eastern Europe
Auestraße 5 - 9
77761 Schiltach / Schwarzwald
europa.southeast@hansgrohe.com

CZ

Hansgrohe
Moravanská 85
CZ-619 00 Brno
Telefon: +420/547 212 334
Telefax: +420/547 212 521

EE

OÜ Dreesis
Laki 16-407
10621 Tallinn
Estonia
Tel.: 00372 61 29 811
Fax: 00372 65 63 310

H

Hansgrohe Kft.
Forgách utca 11-13
1139 Budapest
Telefon: 0036 / 1 236 9090
Telefax: 0036 / 1 236 9098

LT

Santosa
Ulonu 5
LT-08240 Vilnius
Lithuania
Tel.: +37(0) 5 2043291
Fax: +37(0) 5 2043293

PRC

上海市松江工业区俞塘路512号
天威工业城底层
邮编: 201611
电话: 0086-21-57741239
传真: 0086-21-57741233

SRB

Representativa Hansgrohe
Lazar Milosavljevic
Daniceva 5
21000 Novi Sad
Telefon: +381 638 315 183
Telefax: +381 215 277 00

UA

Hansgrohe
Ukrainian office
Vasilkovskaya St., 1, office 301
03040 Kiev
Ukraine
Tel./Fax: 0038 (044) 56 85 012

BiH**MAK****B**

Hansgrohe
Rue Vanderschrick Straat 91
1060 Bruxelles/Brussel
Téléphone: 02 / 5 43 01 40
Telefax: 02 / 5 37 94 86

L**D**

Hansgrohe
D-77757
Schiltach / Schwarzwald
Telefon: 0 78 36 / 51-0
Telefax: 0 78 36 / 51 13 00

F

Hansgrohe
Parc de Haute Technologie
27 rue Georges Besse
92160 Antony
Téléphone: 01 46 11 45 00
Télécopie: 01 46 11 45 39

HR

Representative Hansgrohe
Tomaž Nagode
Riharjeva 2
1000 Ljubljana
Slovenia
Tel.: 00386 1 429 23 32
Fax: 00386 1 429 23 33

NL

Hansgrohe B.V.
Handelsweg 45
NL - 1525 RG Westknollendam
Telefon: 075 6461400
Telefax: 075 6461700

RO

Senso Ambiente S.R.L.
Calea 13 Septembrie 83, bl. 77B
Sektor 5 Bucuresti
Romania
Tel.: 0040 / 21 410 36 72
Fax: 0040 / 22 410 36 51

SGP

Hans Grohe Pte Ltd
60B Martin Road
#11-03/04 Trade Mart Singapore
SINGAPORE 239067
Tel.: 0065-7322002
Fax: 0065-7320030

UK

Hansgrohe
Units D1 & D2 Sandown Park
Trading Estate Royal Mills
Esher Surrey KT10 8BL
Telephone: 0 13 72 46 56 55
Telefax: 0 13 72 47 06 70

BG

Hansgrohe AG
Region Eastern Europe
Auestraße 5 - 9
77761 Schiltach / Schwarzwald
europa.southeast@hansgrohe.com

DK

Hansgrohe
Jegstrupvej 6
8361 Hasselager
Telefon: 86 28 74 00
Telefax: 86 28 74 01

N**FIN**

Hansgrohe
Juhani Niemi Oy
Mäntyltie 11
00270 Helsinki
Puh: (09) 47 77 030
Telefax: (09) 24 17 554

I

Hansgrohe
S.S. 10 KM 24,4
14019 Villanova d'Asti
Telefon: 0 141 / 93 11 11
Telefax: 0 141 / 94 65 94

P

HGAxorPharo SA
R. Antoine de Saint-Exupéry
Alapraia
2765-043 Estoril
Telefon: 21 466 71 10
Fax: 21 466 71 19

RUS

Hansgrohe
Усацнева 3/1
119048 Россия Москва
Tel.: 495 / 9333170
Fax: 495 / 9333171

SI

Representative Hansgrohe
Tomaž Nagode
Riharjeva 2
1000 Ljubljana
Tel.: 00386 1 429 23 32
Fax: 00386 1 429 23 33

USA

Hansgrohe
1490 Bluegrass Lakes Parkway
Alpharetta, GA 30004/USA
Tel.: 770-360-9880
Fax: 770-360-9887

hansgrohe

Hansgrohe · Postfach 1145 · D-77761 Schiltach · Telefon +49 (0) 78 36/51-1282 · Telefax +49 (0) 7836/511440

E-Mail: info@hansgrohe.com · Internet: www.hansgrohe.com

02/2007
9.08973.01